



01



02

01 Outdoor dining - Piazza San Marco

02 Consistent and consolidated zones of outdoor dining - Piazza San Marco

03 Pedestrian priority - shared zones - New Road, Brighton (Gehl Architects)

04 Pedestrian priority - shared zone - Exhibition Road, London

05 Moveable public furniture - Bryant Park

06 Moveable public furniture - Centenary Square, Parramatta



03



04



05



06

Project Opportunities

Customs House Square

Key

1. Existing Customs House Square paving to be retained.
2. New granite paving – flush with pavement.
3. Granite setts or similar.
4. New tree planting.
5. New outdoor dining configuration and materials as per CoS Outdoor Dining Guidelines.
6. Building frontage improvement - The Paragon
7. Projection opportunity.
8. Moveable furniture.

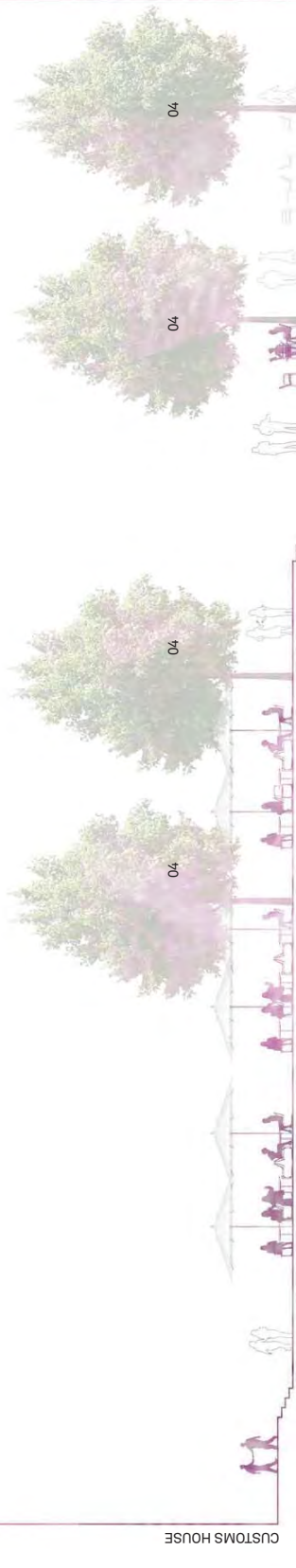

New outdoor dining configuration and furniture as per CoS Outdoor Dining Guidelines. Include Circular Quay and Customs House as a 'Special Precinct' under the City's Outdoor Dining Guidelines, requiring a uniform palette of outdoor dining furniture.

08 - Moveable furniture

Section A-a Customs House Square - Alfred Street

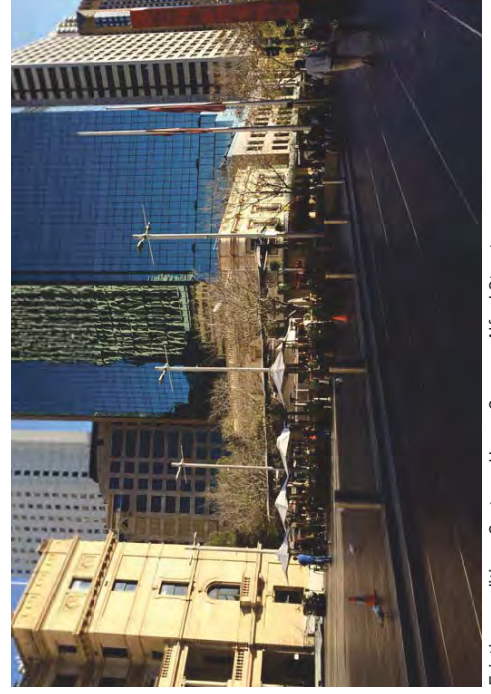

Existing condition - Customs House Square - Alfred Street



Proposed - Illustrative Montage - Customs House Square - Alfred Street

Project Opportunities

Jessie Street Gardens

Project Objectives

Currently Jessie Street Gardens is a “tired” space, located between the Gateway Building and Loftus Street.

The objective is to create one of a series of City Gardens, spaces that are colourful and full of planting that is specific to this site. The intent is to draw the proposed Water Square into the space and open up the constrained spaces behind The Paragon.

Design Principles

- A. Extend the Water Square into the space and create outdoor dining and seating area.
- B. Remove turf areas and create garden area of seasonal planting with intimate seating areas and meandering paths.

Key Project Elements

1. Circular Quay continued along Loftus Street with interpretive overlay.
2. Removal of lower turf area and Circular Quay paving extending into the space creating clear access to the Gateway Entrance and larger outdoor dining and seating areas.
3. Extensive palm planting within the paving to create tree canopy.
4. Large garden area created with intricate and seasonal planting palette.
5. Meandering paths set through the garden areas with seating areas.
6. Outdoor dining elements to be as per City of Sydney Outdoor Dining Guidelines. Include Jessie Street Gardens as a ‘Special Precinct’ under the City’s Outdoor Dining Guidelines, requiring a uniform palette of outdoor dining furniture.
7. Existing monuments retained and repositioned.

Key

1. Circular Quay paving in Loftus Street, with removal of kerbs creating a flush surface.
2. Palm tree planting.
3. Scattered fixed seats under canopy of Palm trees.
4. Seating areas set within Garden.
5. Seasonal, perennial and colourful planting palette.
6. Meandering footpaths.
7. Green wall installation.
8. Outdoor dining zone.

The Jessie Street Garden monuments

- A. The Bonds of Friendship, 1980
- B. Entrance Plaque
- C. Women’s Pioneer Society, 1988
- D. WWII Commemoration Statue of Women in the Defence Force, 1990

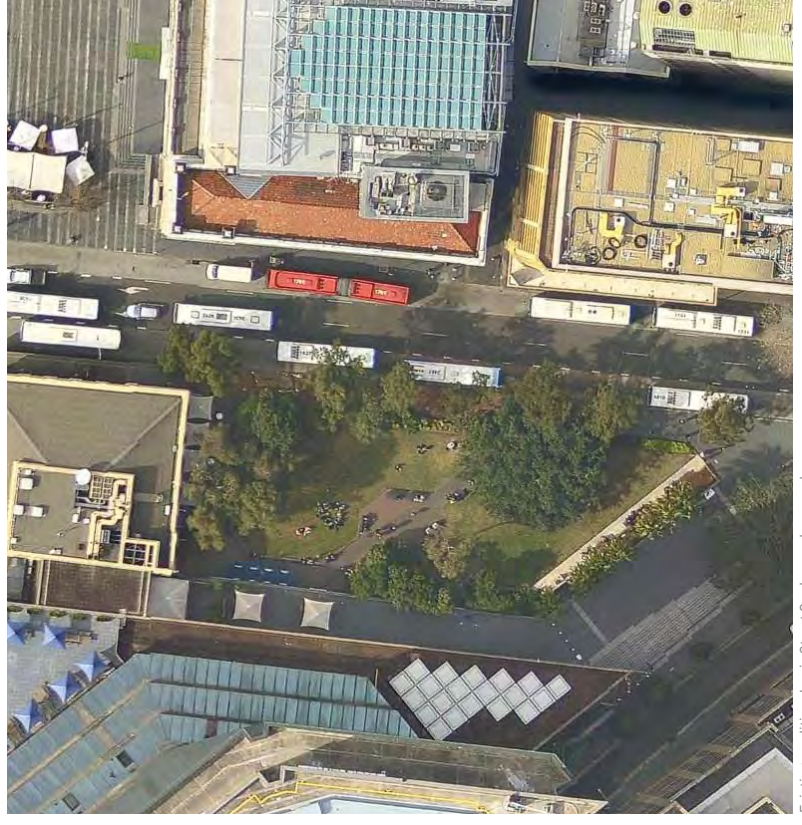

Existing condition: Jessie Street Gardens and surrounds

Project Opportunities Jessie Street Gardens





01



02

01 Scattered seating (fixed)
- Ruskin Parade - Croydon
High Street, London
(HASSELL)

02 Loose, moveable furniture
- Granary Square, London
(Gehl Architects)

03 Pedestrian priority - shared
zone - New Road, Brighton

04 Pedestrian priority - shared
zone - Exhibition Road,
London

05 Plaza Real, Barcelona

06 High quality pavement -
City of Sydney palette



03



04



05

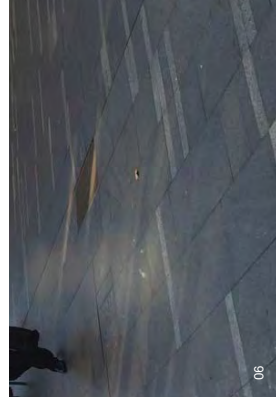

06

Project Opportunities
Jessie Street Gardens



Proposed - Illustrative montage - Jessie Street Gardens



Existing condition - Jessie Street Gardens

Project Opportunities
Jessie Street Gardens

- 01 Pottersfield Park, London
- 02 Pottersfield Park, London
- 03 Pottersfield Park, London



Project Opportunities

Jessie Street Gardens

Key

1. Circular Quay paving in Loftus Street, with removal of kerbs creating a flush surface.
2. Palm tree planting.
3. Scattered fixed seats under canopy of Palm trees.
4. Seating areas set within Garden.
5. Seasonal, perennial and colourful planting palette.
6. Meandering footpaths.
7. Green wall installation.

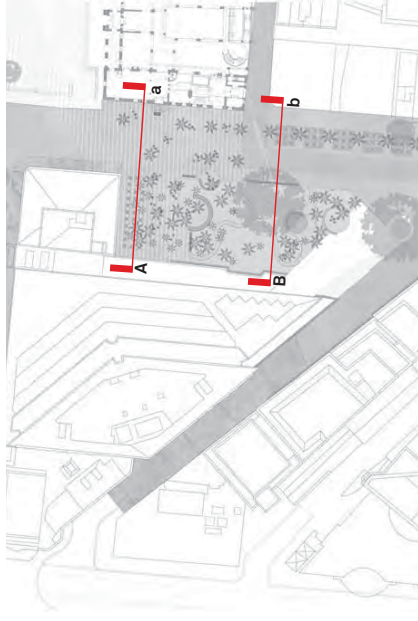

Gateway Building

City garden spaces - seasonal, perennial and colourful planting

Loftus Street - Closed

Customs House

Section A-a:
Jessie Street Gardens



Gateway Building

City garden spaces - seasonal, perennial and colourful planting

Loftus Street - Shared Zone

Loftus Street - Outdoor Dining Zone

Section B-b:
Jessie Street Gardens

Project Opportunities Macquarie Place

Project Objectives

To celebrate Sydney's first Town Square through revealing its historical significance and extending the square to the surrounding building edges.

Design Principles

- Extend Macquarie Square to the surrounding buildings through the creation of flush, paved shared surfaces.
- Lighten space by selective removal of trees, thinning of tree canopies and uplighting to trees.
- Removal of shrub planting to open up views through the park and reveal historic artefacts and memorials.
- Remove areas of worn and shaded turf and replace with low level seasonal planting.
- Removal of obstructions to pedestrian movement, and consolidation of outdoor dining.
- Creation of seating areas for conversation and gathering.

Key Project Elements

- Create pedestrian priority space from Bent Street to The Water Square.
- Reinstate Macquarie Place Gates.
- Creation of new seating alcoves.
- New / re-life planting areas through replanting of seasonal and colourful planting.
- Outdoor dining elements to be as per City of Sydney Outdoor Dining Guidelines. Include Macquarie Place as a 'Special Precinct' under the City's Outdoor Dining Guidelines, requiring a uniform palette of outdoor dining furniture.
- Theatrical uplighting to the fig trees.
- Reactivation of the "Mens Lavatory" as F&B offering.

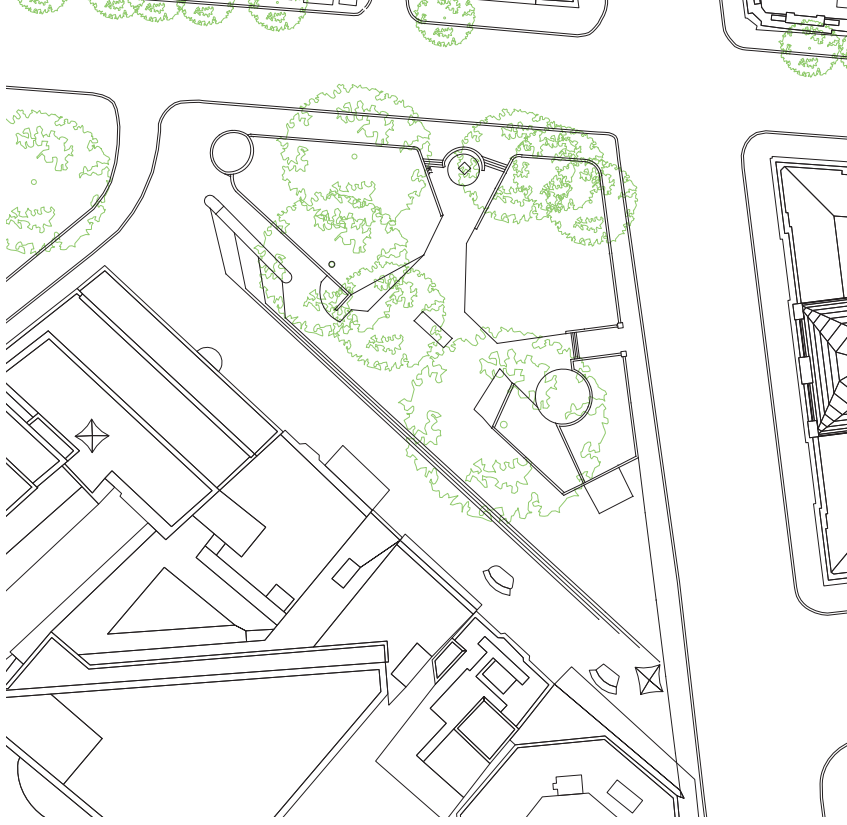

Existing condition: Macquarie Place and surrounds

Key

- Declutter a clear passage from Bridge Street to the Harbour.
- Reconfigure the outdoor dining to allow free movement in and out of the park.
- Theatrical uplighting to the trees.
- Replanting of garden areas and removal of turf in shaded areas.
- Reinstate Macquarie Place gates.
- Creation of new seating alcoves.
- Outdoor dining elements to be as per City of Sydney Outdoor Dining Guidelines. Include Macquarie Place as a 'Special Precinct' under the City's Outdoor Dining Guidelines, requiring a uniform palette of outdoor dining furniture.
- Reactivate the "Mens Lavatory."
- New street tree planting - Livistona australis.
- New paved areas.
- Existing paving retained.
- Remove Ficus hillii.

The Macquarie Place monuments

- A Mens Lavatory, 1807
- B Canopy Fountain, 1870
- C Salvaged Anchor from HMS 'Sirius', 1907
- D Salvaged Cannon from HMS 'Sirius', 1907
- E Macquarie Obelisk, 1818
- F Queen Elizabeth - Tree Planting 1954
- G Duke of Edinburgh - Tree Planting 1854
- H Remembrance Driveway Plaque 1995
- I Statue of TS Mort (Pierce Francis Connelly), 1883
- J Bronze Memorial Fountain (Gerald Lewers), 1960
- K The Distance of Your Heart (Tracey Emin)

Project Opportunities Macquarie Place

Master Plan - Macquarie Place
Scale 1:400@A3





01



02

OPPORTUNITIES FOR THE CREATION OF IMMERSIVE GARDEN SPACES - ENGAGING AND BEAUTIFUL CITY GARDEN SPACES THAT ENLIVEN THE EAST WEST JOURNEYS THROUGH THE CITY - SPACES TO SIT, SPACES TO EAT, SPACES TO RELAX.



03



04



05

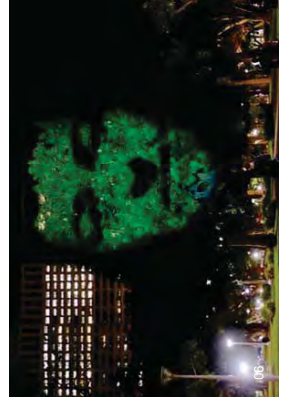

06

Place.

- 01 Multi-layered, lush understory planting to thrive in the shaded conditions of Macquarie Place.
Reference Project: Gardens by the Bay, Singapore
- 02 A detailed planting palette.
Reference Project: Gardens by the Bay, Singapore
- 03 A shade tolerant palette.
- 04 Multi-layered, lush understory planting to thrive in the shaded conditions of Macquarie Place.
Reference Project: Pottersfield Park, London
- 05 Creation of beautiful Gardenspaces to sit within.
Reference Project: Pottersfield Park, London
- 06 Possible theatrical and experiential lighting / projections opportunities within the existing tree canopy.
Reference Project: Craig Walsh - "Emergence", a series of ghostly, colorful projections of faces onto

Project Opportunities Macquarie Place

Dining and activation - Activating the Men's Lavatory

- 01 The existing 'Mens Lavatory'
- 02 The Temple of Convenience, Manchester, UK
A former public toilet, this subterranean bar is now one of the coolest places to hang out in Manchester.

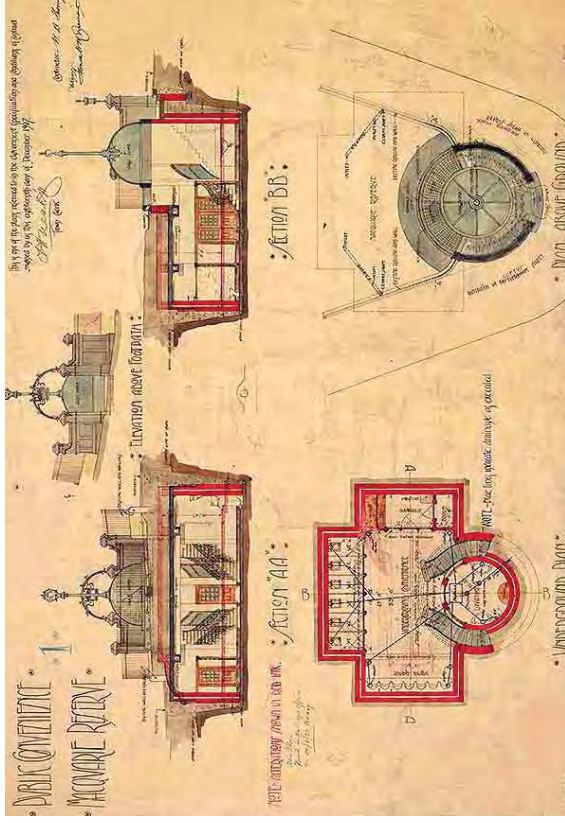

01

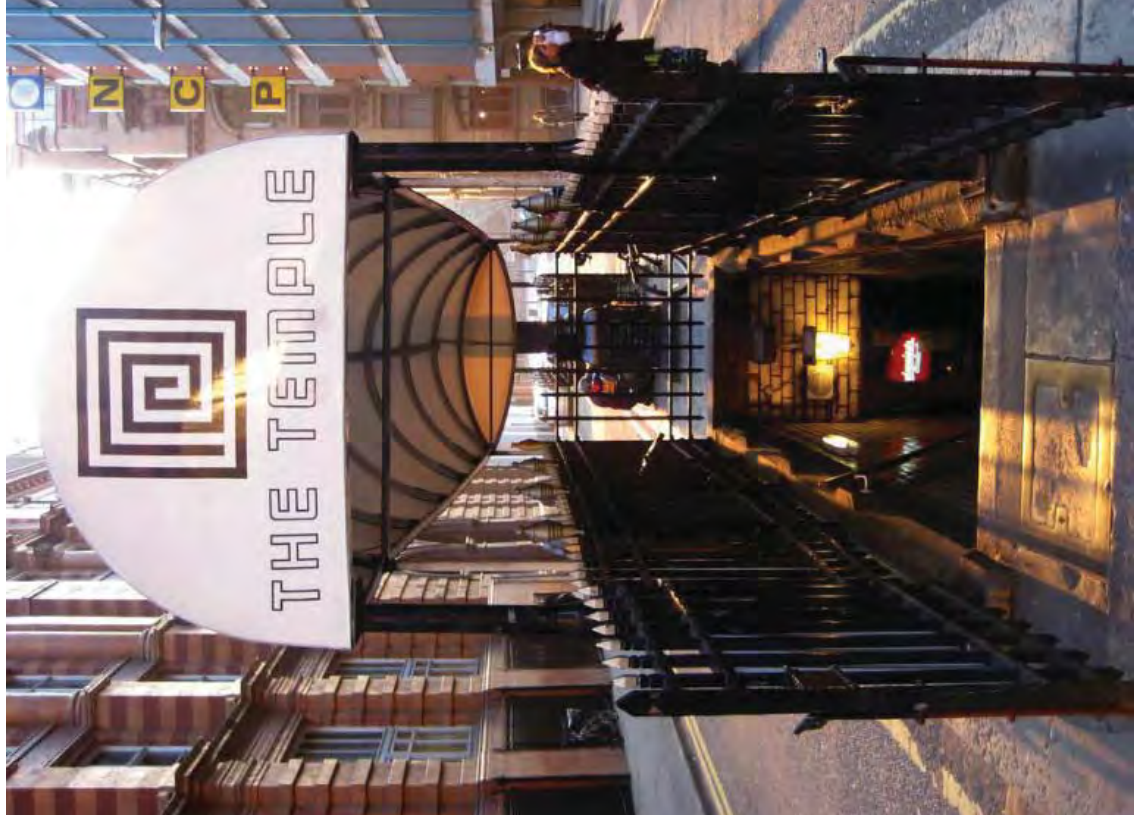

02

Project Opportunities Macquarie Place

Key

1. Declutter a clear passage from Bridge Street to the Harbour.
2. Reconfigure the outdoor dining to allow free movement in and out of the park.
3. Theatrical uplighting to the trees.
4. Replanting of garden areas and removal of turf in shaded areas.
5. Reinstate Macquarie Place gates.
6. Creation of new seating alcoves.
7. Outdoor dining elements to be as per City of Sydney Outdoor Dining Guidelines.
8. Reactivate the "Mens Lavatory."
9. New street tree planting.

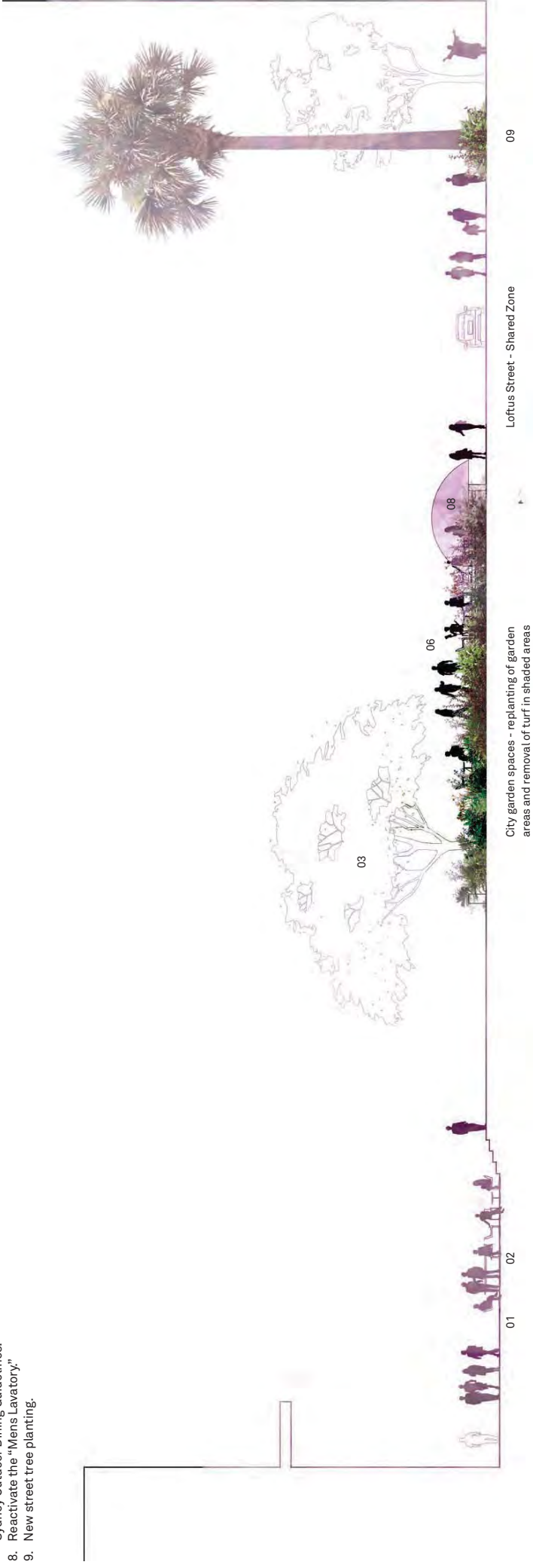
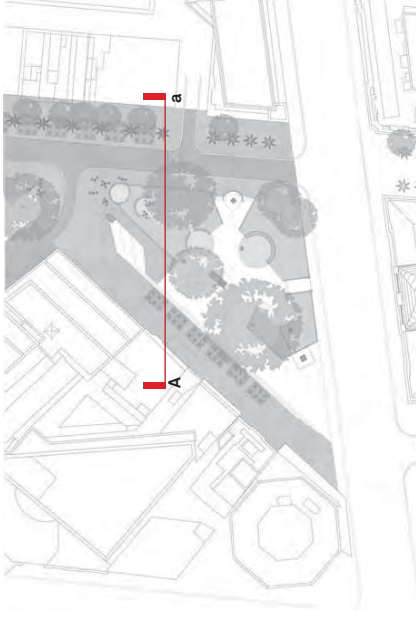

City garden spaces - replanting of garden areas and removal of turf in shaded areas

Section A-a: Macquarie Place



01 Existing condition - Macquarie Place.

02 Macquarie Place Concept Illustration - Reimagining the heritage underground toilets into an attraction - F&E and activating the area with moveable seating.

03 Proposed - Illustrative Montage - Macquarie Place. Creating a pedestrian priority area - facilitating easier access - permeability and creating beautiful places for people to stop and relax.

Project Opportunities

Reiby Place

Vertical greening of Reiby Place and interpretation of the water mark through artworks and projection.

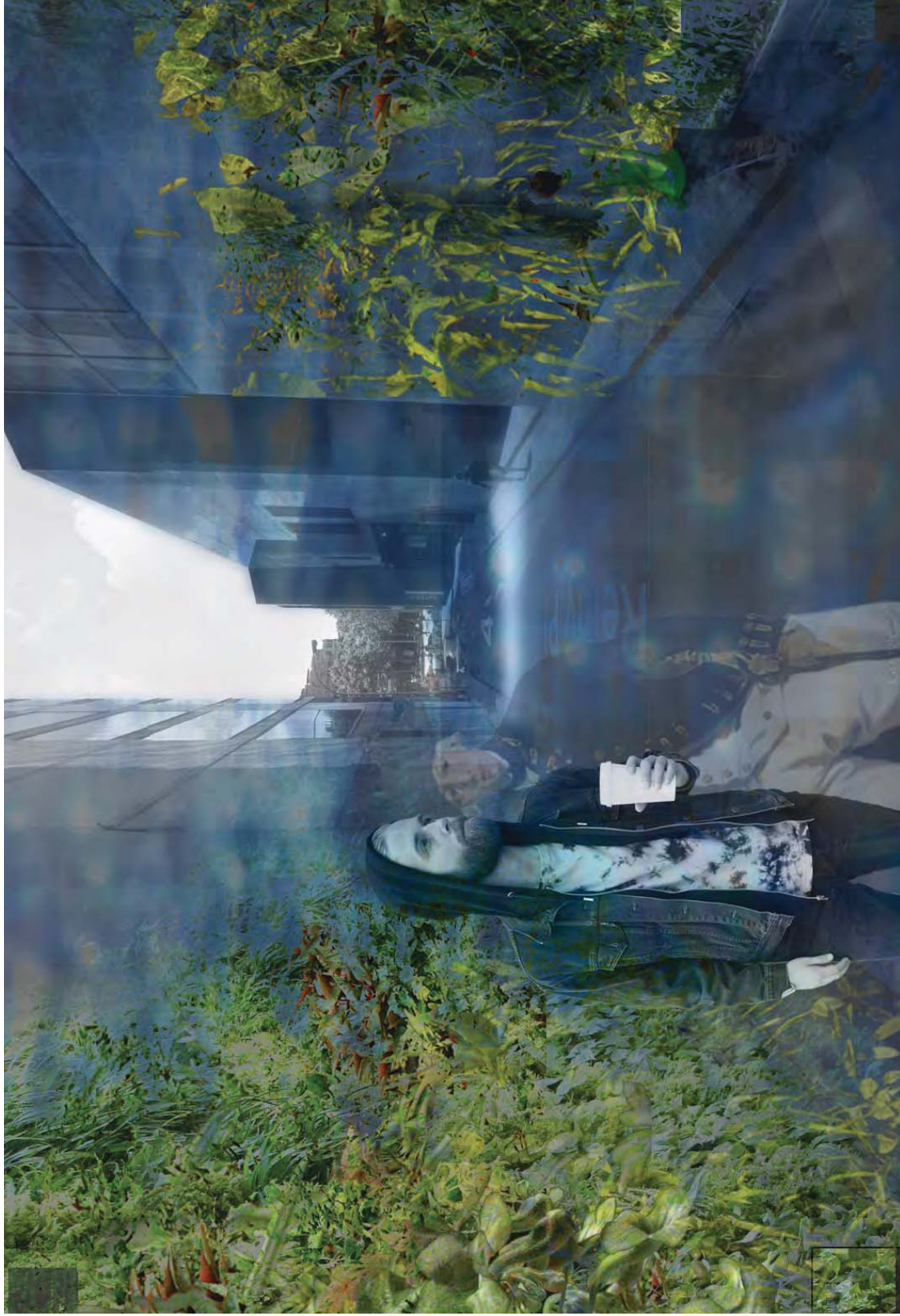

Concept illustration - Reiby Place green walls and theatrical lighting installations. Lush, green, immersive planting palette - inspired by poetic descriptions of the pre-settlement landscape character.



Existing condition - Reiby Place



01



02

- 01 Traces - Blue (Craig Walsh & Hiromi Tango - in collaboration with the people of Teshima Island) Setouchi triennale, Teshima Island, Japan, 2013
- 02 Blurring the Boundaries (Craig Walsh) Vietnam Institute of Architects, Hanoi, Vietnam, 2001
- 03 Greenwall planters - Gardens by the Bay, Singapore
- 04 Planting projection - Gertrude Street Projection Festival, Melbourne
- 05 Living Technologies Garden - Google campus, London
- 06 Medibank Building, Bourke Street, Melbourne



03



04



05



06

Project Opportunities

Farrer Place

Project Objectives

To enliven and activate Farrer Place to make it more comfortable and inviting and allow free pedestrian movement.

Design Principles

- A. Relocation and redesign of the kiosks to allow for better pedestrian circulation.
- B. Create better opportunities for seating and gathering.
- C. New planting palette to enliven the space and inspired by the poetic descriptions of the pre-settlement landscape character.
- D. Reinterpret 1970's paving pattern to enliven space.
- E. Shared surface in Loftus Street.
- F. Retain significant urban vista from Governor Macquarie Tower lobby/entrance to clocktower.

Key Project Elements

1. Relocate existing kiosks from Bent Street footpath into Farrer Place, redesigned "in the round."
2. Re-purpose existing planters, adding seating edges.
3. Application of pavement graphic - painting or subtle surface treatment.
4. New, lush, green and immersive planting palette.



Existing condition: Farrer Place and surrounds

Key

1. Relocated and redesigned kiosks.
2. Seating applied to existing planters.
3. Application of pavement graphic.
4. New planting palette.
5. Flush paving in Loftus Street.
6. New planters incorporating edge seating element.

Project Opportunities
Farrer Place

Master Plan - Farrer Place
Scale 1:400@A3



Project Opportunities

Farrer Place

Project reference:
Farrer Place - 1974

"The triangular traffic island in Farrer Place has been temporarily linked to the northern footpath to create a mini plaza with seating and landscaping. The City Council hopes to be able to transform this area permanently and to make Farrer Place into a proper place for people to enjoy."

Source_ <http://trove.nla.gov.au/work/>



Farrer Place (1974)

Project Opportunities
Farrer Place

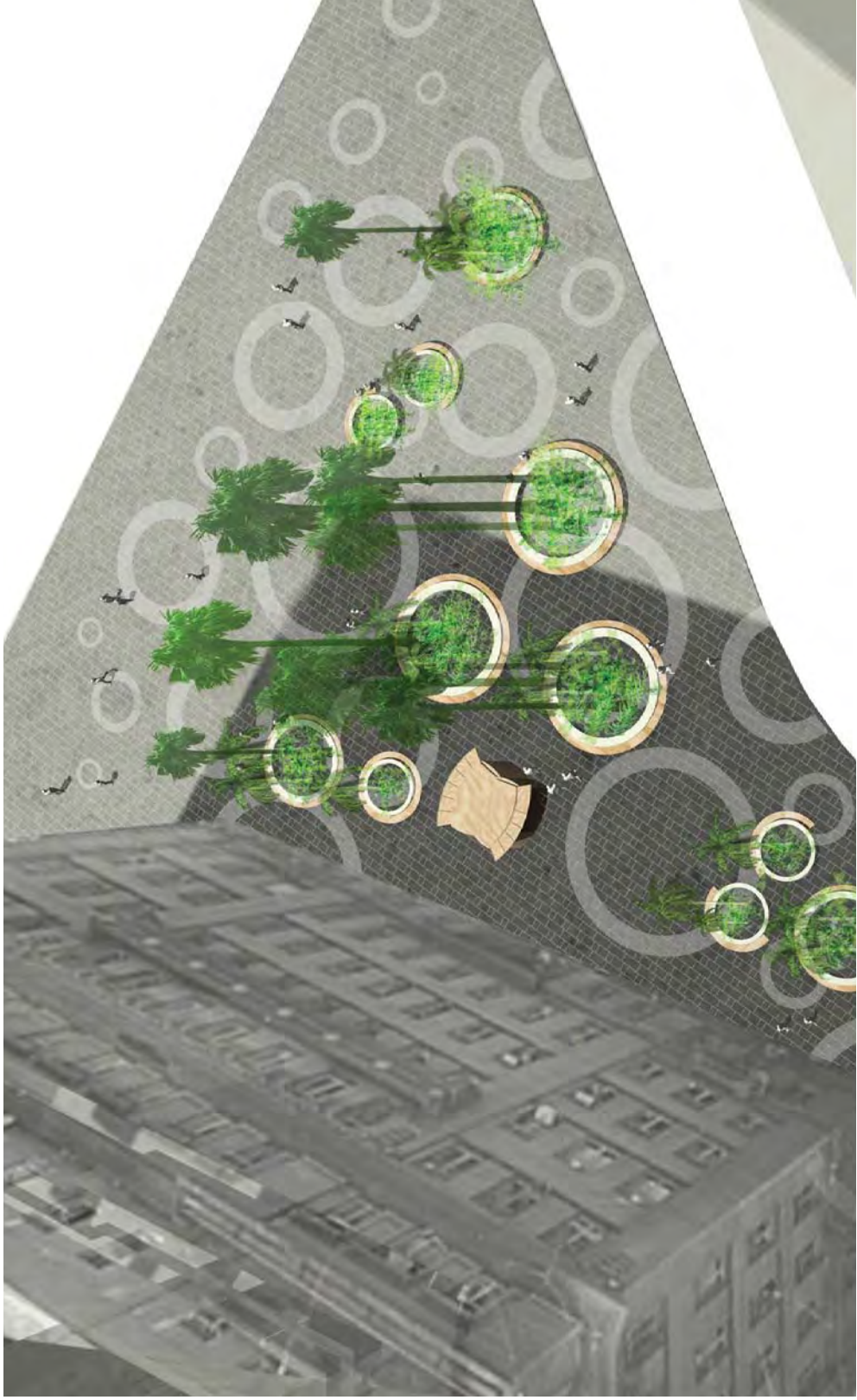

Concept illustration - Reinvigoration of Farrer Place, celebrating its position in the heart of the financial CBD. Lush, green, immersive planting palette - inspired by poetic descriptions of the pre-settlement landscape character.

Project Opportunities

Farrer Place



Proposed - Illustrative Montage - Farrer Place Upgrade



Existing condition - Farrer Place

This page intentionally blank

Traffic and Transport

Traffic and Transport

Buses

A Young Street - Proposed west side bus layover zone capacity = 3

B Phillip Street- Proposed west side bus layover zone capacity = 4

C Phillip Street- Existing central bus layover zone capacity = 4

Taxi's

D Pitt Street Taxi Rank - Preferred location
The proposed Pitt Street east side taxi zone has a capacity of 10 taxis.

E Loftus Street 'Shared Zone' - taxi's would enter via Loftus and Reiby Place to arrive at the rank in Pitt Street.

Lane Widths

Lane widths are 3.3m.



Traffic and Transport

Traffic and Transport

Shared Zones

- Shared zones must meet the following
- Current traffic flows of less than 100 vehicles per hour and 1000 vehicles per day
 - Total length of less than 400m
 - Not located along bus routes or heavy vehicle routes, except for delivery or garbage trucks

While we have the proposed traffic for the Quay Quarter site and for Customs House, we do not have details for other existing properties which are serviced from Reiby Place and Loftus Lane. We have been able to identify at least three, not including the Gateway building, whose entrance is at the corner of Pitt St and Reiby Place. However, based on the traffic volumes determined for Quay Quarter, we have assessed that the traffic volumes due to the driveways are likely to be in the order of 80 vehicles per hour max and 500 vehicles per day. Vehicle counts in Reiby Place could well be required to confirm this.

Based on this initial assessment, traffic volumes will be suitable for a shared zone in the majority of Loftus St and Reiby Place, once Loftus St is closed to through traffic.

In Reiby Place, the shared zone will need to end before the driveway into the Gateway building. This driveway serves Wilson Parking, and will result in traffic volumes that exceed the limits for a shared zone.

While we believe that traffic volumes should be suitable in a closed off Loftus St, it is possible that they will be too high in the northern section, between Bridge St and Loftus Lane. It may be that the shared zone will need to start just after the laneway.

Key

Shared Zone

1. Loftus Street and Customs House Lane.
2. Reiby Place - creation of a shared space with taxis accessing Pitt Street.

Street Closure

3. Loftus Street north of Customs House Lane.



Heritage

The heritage provisions of the City of Sydney Local Environment Plan (LEP) 2012 and the City of Sydney Development Control Plan (DCP) 2012 will apply to any work undertaken in this precinct, as a result, City Plan Services provided heritage design advice during this stage of the project. A Heritage Impact Statement will be required with future phases of work in the precinct.

This area holds a great amount of historical context for the City of Sydney and the level of significance is therefore very high. The subject site is populated with numerous local and state heritage items as listed in Schedule 5 of the City of Sydney Local Environment Plan (LEP) 2012 and NSW Heritage Act 1977, and will need to be considered during any detailed design phase.

Some examples include:

- Macquarie Place, including road reserves, park reserve, "Macquarie Obelisk", "Sirius" anchor and canon, "TS Mort" statue, public conveniences, "Christie Wright" memorial fountain, memorial gate pillars, sandstone fence and archaeology, I1856 (State)
- Former Customs House, 31 Alfred Street, I1661 (State)
- "AMP Building" including interior, 33 Alfred Street, I1662 (Local)
- Former "Department of Lands" building including interior, 23-33 Bridge Street, I1683 (State)
- Department of Education building including interior, 35-39 Bridge Street, I1684 (State)
- Paragon Hotel facades and interior, 1 Macquarie Place, I1857, (Local)
- Former Ship Inn façade, 1 Macquarie Place, I1858, (Local)
- Former "Barker's Wool and Produce Stores" including interiors, 12-14 Loftus Street, I1855 (Local).

The Bridge Street sandstone buildings together with those in Macquarie Street were also recently nominated for the national list.

Heritage Issues

General

- The works are generally acceptable though further detailed analysis is required.
- Any sandstone kerbs should remain in situ and in-laid as an interpretative element.
- Much of the study area is listed on the State Heritage Register (SHR). Sites listed on the SHR will be subject to an Integrated Development Application and subsequent s60 Application to Heritage Division.
- The proposed 'de cluttering' or various precincts is a highly desirable heritage outcome.
- The proposed interpretative strategies are generally a positive heritage outcome.
- Consideration will need to be given to location of services (ie. Electricity cables) and the impact of any excavation of potential archaeological remains.
- Maintenance of existing views and vistas should be a key consideration for the proposal, though these have generally been well maintained under the current scheme.

Macquarie Place

- Significant plantings and path alignments must be retained in Macquarie Place and path alignments must be retained. Further historical investigation and review of documentation is required in this regard.
- The proposed adaptive reuse of the WC block at Macquarie Place is acceptable in principle, subject to design detailing and site inspection.
- The proposed reinstatement of gates to Macquarie Place may be acceptable, subject to detailed design and historical analysis.

This page intentionally blank

Australia	China	South East Asia
Adelaide	Beijing	Bangkok
HASSELL	HASSELL	HASSELL
Level 1	501, Tower B	Level 26 Sathorn City Tower
82 Waymouth Street	Raycom Wangjing Centre	175 South Sathorn Road
Adelaide SA	Chaoyang District	Thungmahamek
Australia 5000	Beijing 100102 China	Sathorn Bangkok 10120 Thailand
T +61 8 8220 5000	T +8610 5126 6908	T +66 818 758 300
E adelaide@hassellstudio.com	E beijing@hassellstudio.com	E bangkok@hassellstudio.com
Brisbane	Hong Kong SAR	Singapore
HASSELL	HASSELL	HASSELL
36 Warry Street	22F, 169 Electric Road	33 Tras Street #02-01
Fortitude Valley QLD	North Point Hong Kong SAR	078973 Singapore
Australia 4006	T +852 2552 9098	T +65 6224 4688
T +61 7 3914 4000	E hongkong@hassellstudio.com	E singapore@hassellstudio.com
E brisbane@hassellstudio.com		
Melbourne	Shanghai	United Kingdom
HASSELL	HASSELL	
61 Little Collins Street	Building 8 Xing Fu Ma Tou	Cardiff
Melbourne VIC	1029 South Zhongshan Road	HASSELL
Australia 3000	Huangpu District	4th Floor, James William House
T +61 3 8102 3000	Shanghai 200011 China	9 Museum Place
E melbourne@hassellstudio.com	T +8621 6887 8777	Cardiff CF10 3BD United Kingdom
	E shanghai@hassellstudio.com	T +44 29 2072 9071
		E cardiff@hassellstudio.com
Perth	Shenzhen	London
HASSELL	HASSELL	HASSELL
Podium Level, Central Park	Room 202 Block B3 OCT loft	Level 2, Morelands
152 – 158 St Georges Terrace	East Industry Zone	17 – 21 Old Street
Perth WA	Nanshan District	Clerkenwell
Australia 6000	Shenzhen 518053 China	London EC1V 9HL United Kingdom
T +61 8 6477 6000	T +86755 2381 1838	T +44 20 7490 7669
E perth@hassellstudio.com	E shenzhen@hassellstudio.com	E london@hassellstudio.com
Sydney		
HASSELL		
Level 2		
Pier 8/9, 23 Hickson Road		
Sydney NSW		
Australia 2000		
T +61 2 9101 2000		
E sydney@hassellstudio.com		